

FOR HIGHER PRESSURES, SIZES, MATERIALS AND THREAD CONNECTIONS, PLEASE CONSULT

ORDER EXAMPLE: U030 A03 V 1 AI

Capacity: 2,6 litres
 A03≡30bar
 V= FKM Rubber Bladder
 1" Standard Connection
 Body & insert material: AISI 316L

- A02≡20bar
- A03≡30bar
- A04≡40bar
- A05≡50bar
- A18≡180bar
- A26≡260bar

Wall thickness acc. to AD-2000 code

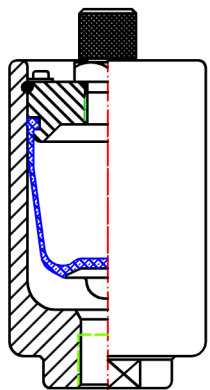

U001 to U003

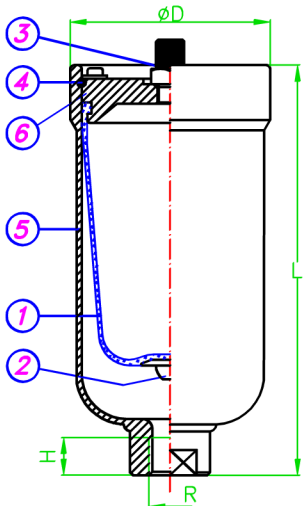

U007 to U250

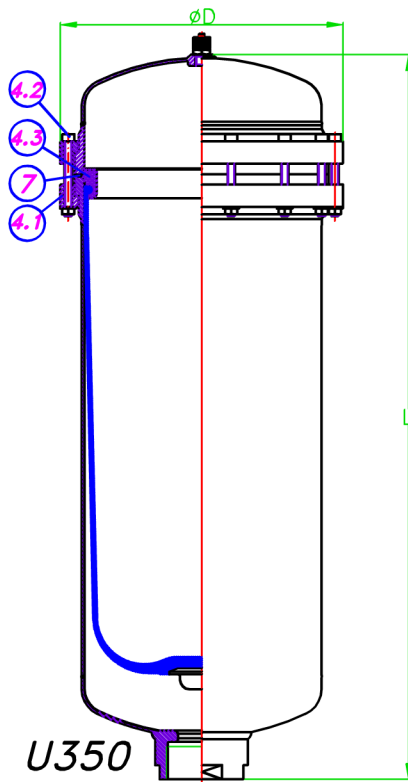

U350

Value of "K": $\frac{\text{Maxi. Pressure}}{\text{Filling gas Pressure}} \leq K$ (@Constant Temp.)

PULSATION DAMPER Reference	VOLUME (litres)	DESIGN PRESSURE (bar-g @20°C)	D (mm)	L (mm)	R (BSP)	H (mm)	WEIGHT (Kg)	K VALUE
U001	0.09	260	55	100	3/8"	14	0.1	2.5
U002	0.18	180	70	118	1/2"		1.8	
U003	0.36		85	161		3/4"	16	3.6
U007	0.65	50	90	205	20		2.5	
U010	0.95	40	110	200	25		4.3	3.0
U015	1.50			245		4.6		
U030	2.60	30	140	295	27	5.3	5.0	
U040	3.80			390		5.7		
U060	5.60	40	170	414	30	10.0	4.0	
U100	10.40			30		220		442
U150	15.00	625	18.5		5.0			
U250	25.00	20	270	691		27	26.0	4.0
U350	35.00			302	797		28.5	

7	"O" RING	1	NBR, EPDM & FKM
6	COVER	1	AISI 316L
5	BODY	1	AISI 316L
4.3	RETAINING RING	1	St-52Elec. Nickel plat.
4.2	BOLTS & NUTS	14	DIN 912 & 934 A4-70
4.1	RETAINING RING	2	St-52Elec. Nickel plat.
4	RETAINING RING	1	DIN17224 (AISI 316L)
3	INFLATING N2 VALVE	1	AISI 316L (1/4" BSP)
2	INSERT	1	AISI 316L
1	BLADDER	1	NBR, EPDM & FKM
No	DENOMINATION	QT.	MATERIALS

H = MAXI. LENGTH OF THREAD CONNECTION

Standard Bladder Rubbers: N=NBR, E=EPDM, V=FKM

(Other Rubbers: Butyl, Hypalon, HNBR, etc.)

Rubbers Max. Working Temperatures (°C)

	N	E	V
	+80	+130	+170
	-15	-30	-10

Working Temperatures versus Working Pressures **

For a temperature of 80°C correspond design pressure x 0.87

" " " " 130°C " " " x 0.78

" " " " 170°C " " " x 0.72

TOLERANCES:
External dimensions: ±3%
Volume: ±2.5%
Weight: ±5%

THE MAXI TEMPERATURE CAN BE REDUCED DEPENDING ON THE LIQUID IN CONTACT

ATTENTION! ALWAYS MUST BE MOUNTED VERTICALITY (VALVE 3 ON TOP)

Those Pulsation Dampeners ought to be filled with gas at a value of 0.80x the pressure to stabilize and that at the working temperature

NOTE: The precharge with gas or air must be done slowly and with our charging tool Ref. BV160A1TM



HIDRACAR SA
 08295 S.VTE. CASTELLET
 (BARCELONA) SPAIN

TEL.34.93.8330252 FAX.34.93.8331950

Customer

Title S.S.MEDIUM & LOW PRESSURE
 BLADDER PULSATION DAMPERS (standard units)

Customer Ref.

Replaced Drg.N°

AV.AI.MP-BP.IN.DOC(Rev.16)

Drg.No

AV.AI.MP-BP.IN.DOC.

Drawn

E.Ponsa

Rev. 17

Approved

M.Carcaré

Date Scale

Nov-14 none